

# QUICK START GUIDE



SC1



SCHUBERTH

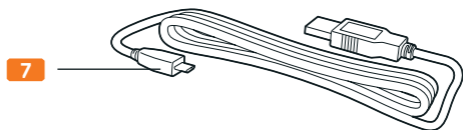
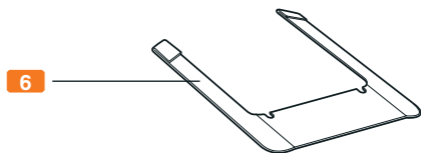
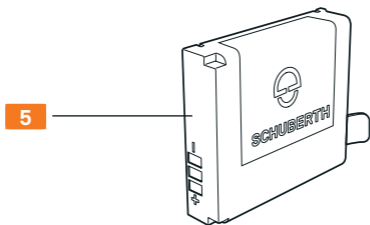
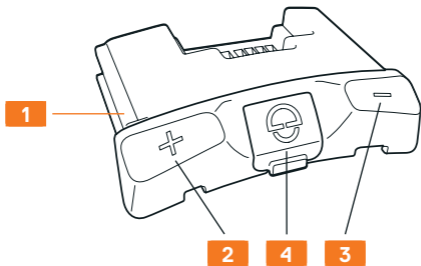

1 SC1

2  Tast

3  Tast

4 Ladeport

5 Batteri

6 Værktøj

7 USB Ladekabel

## Installation

SCHUBERTH C4

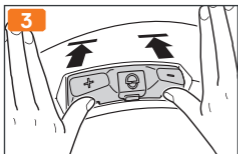
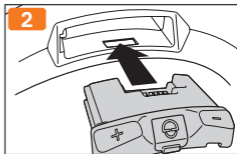
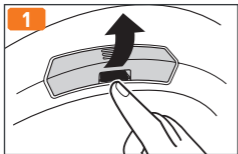

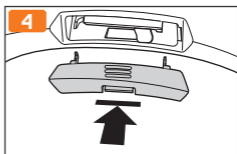
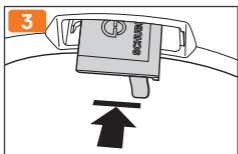
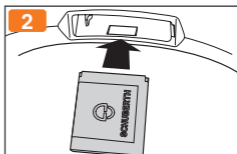
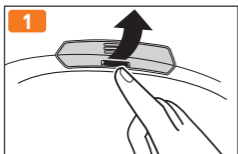

SCHUBERTH R2

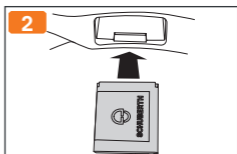
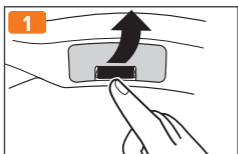
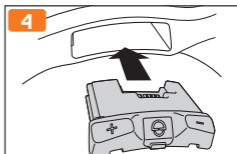
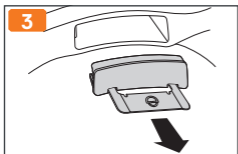
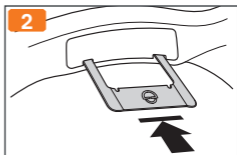
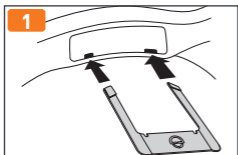

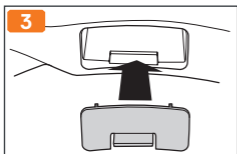

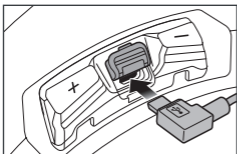

## Opladning



## Tastebetjening - vejledning

	Et (1) kort tryk
	To (2) korte tryk
 1sek	1 sek tryk (langt tryk)

# Grundfunktioner

Power On

 &   1sek

Power Off

 &   3sek

Volume justering

## Interkom

Parring ( skal kun gøres en gang pr parring)





Headset A

Headset B

-   1sek        1sek (husk det er lange tryk)
-          Kort tryk
-  

## Start gruppe interkom

  **1sek** (husk det er lange tryk)

  **1sek** (husk det er lange tryk)

## Afbryde gruppe interkom

  **3sek**

## Mobiltelefon

### Parring af mobiltelefon

1.  eller   **10sek** (til du hører "Configuration menu")

2.    tryk 2 gange for at bladre til parring af telefon 1

Find Sena under bluetooth på mobil

### Besvare et opkald

### Afslutte opkald

  **2sec**

## Stemmeopkald

  3sec

## Afvis opkald

  2sec

## Parring af GPS

1.  eller   10sek

2.     tryk 3 gange for at blade til menupunkt parring af GPS



## Musik

Play & Pause Bluetooth musik



Næste nummer



## FM Radio

Radio On & Off \*



Søg station



\*: Gælder kun

SC1 **ADVANCED**

## Smartphone App



🔍 SCHUBERTH



## Værd at vide:

Man kommer i menuen ved at holde plus eller minus ned i 10 sekunder.

Når man er i menuen kan man bladre i menuen ved at trykke 1 gang på + hvert tryk på + bladrer et punkt i menuen.

Når man er nået til sidste menupunkt starter listen forfra.

**OBS! Nogle menupunkter kræver man kvitterer med - (minus) tasten for at aktivere.**